

|     |
|-----|
| 36x |
| 35x |
| 34x |
| 33x |
| 32x |
| 31x |
| 30x |
| 29x |
| 28x |
| 27x |
| 26x |
| 25x |
| 24x |
| 23x |
| 22x |
| 21x |
| 20x |

|     |     |
|-----|-----|
| 138 | 160 |
| 137 | 159 |
| 136 | 158 |
| 135 | 157 |
| 134 | 156 |
| 133 | 155 |
| 132 | 154 |
| 104 | 123 |
| 102 | 124 |
| 103 | 153 |
| 100 | 152 |
| 101 | 151 |

|     |     |
|-----|-----|
| 184 | 208 |
| 183 | 207 |
| 182 | 206 |
| 181 | 205 |
| 180 | 204 |
| 179 | 203 |
| 178 | 202 |
| 177 | 201 |
| 176 | 200 |
| 175 | 199 |
| 174 | 198 |
| 173 | 197 |
| 57  | 58  |

|     |     |
|-----|-----|
| 220 | 232 |
| 219 | 231 |
| 218 | 230 |
| 217 | 229 |
| 216 | 228 |
| 215 | 227 |
| 214 | 226 |
| 213 | 225 |
| 212 | 224 |
| 211 | 223 |
| 210 | 222 |
| 209 | 221 |

|           |     |
|-----------|-----|
| Wash Rack |     |
| 242       | 252 |
| 241       | 251 |
| 240       | 250 |
| 239       | 249 |
| 238       | 248 |
| 237       | 247 |
| 236       | 246 |
| 235       | 245 |
| 234       | 244 |
| 233       | 243 |
| 55        | 56  |

|     |     |
|-----|-----|
| 264 | 276 |
| 263 | 275 |
| 262 | 274 |
| 261 | 273 |
| 260 | 272 |
| 259 | 271 |
| 258 | 270 |
| 257 | 269 |
| 256 | 268 |
| 255 | 267 |
| 254 | 266 |
| 253 | 265 |

|     |     |
|-----|-----|
| 300 | 324 |
| 299 | 323 |
| 298 | 322 |
| 297 | 321 |
| 296 | 320 |
| 295 | 319 |
| 294 | 318 |
| 293 | 317 |
| 292 | 316 |
| 291 | 315 |
| 290 | 314 |
| 289 | 313 |

|     |     |
|-----|-----|
| 348 | 372 |
| 347 | 371 |
| 346 | 370 |
| 345 | 369 |
| 344 | 368 |
| 343 | 367 |
| 342 | 366 |
| 341 | 365 |
| 340 | 364 |
| 339 | 363 |
| 338 | 362 |
| 337 | 361 |

|    |    |
|----|----|
| 1  | 48 |
| 2  | 47 |
| 3  | 46 |
| 4  | 45 |
| 5  | 44 |
| 6  | 43 |
| 7  | 42 |
| 8  | 41 |
| 9  | 40 |
| 10 | 39 |
| 11 | 38 |
| 12 | 37 |

|     |
|-----|
| 19x |
| 18x |
| 17x |
| 16x |
| 15x |
| 14x |
| 13x |
| 12x |
| 11x |
| 10x |
| 9x  |
| 8x  |
| 7x  |
| 6x  |
| 5x  |
| 4x  |
| 3x  |
| 2x  |
| 1x  |

|     |     |
|-----|-----|
| 59  | 60  |
| 131 | 150 |
| 130 | 149 |
| 129 | 148 |
| 128 | 147 |
| 127 | 146 |
| 126 | 145 |
| 125 | 144 |

|     |     |
|-----|-----|
| 172 | 55x |
| 171 | 54x |
| 170 | 53x |
| 169 | 52x |
| 168 | 51x |
| 167 | 50x |
| 166 | 49x |
| 165 | 48x |
| 164 | 47x |
| 163 | 46x |
|     | 45x |
|     | 44x |
|     | 43x |
|     | 42x |
|     | 41x |
|     | 40x |
|     | 39x |
|     | 38x |
|     | 37x |

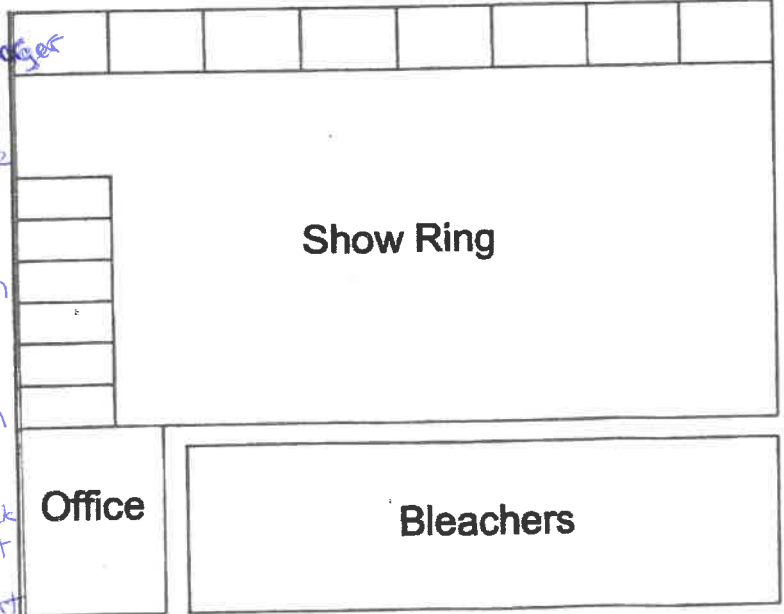

|     |     |
|-----|-----|
| 53  | 54  |
| 288 | 312 |
| 287 | 311 |
| 286 | 310 |
| 285 | 309 |
| 284 | 308 |
| 283 | 307 |
| 282 | 306 |
| 281 | 305 |
| 280 | 304 |
| 279 | 303 |
| 278 | 302 |
| 277 | 301 |

|     |     |
|-----|-----|
| 51  | 52  |
| 336 | 360 |
| 335 | 359 |
| 334 | 358 |
| 333 | 357 |
| 332 | 356 |
| 331 | 355 |
| 330 | 354 |
| 329 | 353 |
| 328 | 352 |
| 327 | 351 |
| 326 | 350 |
| 325 | 349 |

|    |    |
|----|----|
| 49 | 50 |
| 13 | 36 |
| 14 | 35 |
| 15 | 34 |
| 16 | 33 |
| 17 | 32 |
| 18 | 31 |
| 19 | 30 |
| 20 | 29 |
| 21 | 28 |
| 22 | 27 |
| 23 | 26 |
| 24 | 25 |

2019

| Exhibitor  | Pen number   | Exhibitor    | Pen number       |
|------------|--|--------------|------------------|
| Amy        | 55X, 48X, 42X, 1K, 2X, 8X, 14X, 168<br>246, 340, 317 | Greiner      | 200              |
| Ace        | 163  | Hardesty     | 201-207          |
| Arlene     | 151, 152   | Hargrove     | 16X, 17X         |
| Baker      | 287, 288   | Harrison     | 282, 283         |
| Barnhart   | 37X  | Hearn        | 214-217          |
| Barwick    | 40X  | Hendricks    | 179-183          |
| Bauer      | 278, 279   | Hereth       | 280-281          |
| Berner     | 20X-36X, 135-138                                     | Higgs        | 46X              |
| Blizzard   | 171  | Hockenberry  | 167              |
| Boden      | 45X  | Hodiak       | 243-245          |
| BOBER      | 265-267  | Hough        | 254-264          |
| Brown      | 146  | Mantua       | 253              |
| Carson     | 323  | Huneycutt    | 164              |
| Chamelin   | 169-170  | Ivey         | 145              |
| Chaap      | 153  | Jackson      | 126, 11X         |
| Clum       | 177  | Jacobs       | 149              |
| Cook       | 316  | Kaffenbarger | 53X, 54X         |
| Crampton   | 289-291  | Keeney       | 52X              |
| Cabbage    | 51X  | Kinnaman     | 313-315          |
| Enoff      | 132-134  | Kiser        | 44X              |
| Willowdale | 124  | Knatz        | 301-303, 325-327 |
| Ferguson   | 173-174  | Lacher       | 41X              |
| Flotr      | 333-336  | Lucabaugh    | 332              |
| Foster     | 273-276  | Ludwig       | 129, 15X         |
| Francis    | 50X  | Mansfield    | 52-353           |
| Gill       | 218-219  | Marker       | 166              |
| Gladhill   | 209-212  | Mc Clements  | 341-348          |
| Glowacki   | 370-371  | Mc Conn      | 172              |
| Gordon     | 123  | Mc Gunnis    | 158-159          |
| Gover      | 144  | Michael      | 49X              |
|            |  | Miles        | 358-360          |

| Exhibitor        | Pen number | Exhibitor    | Pen number    |
|------------------|------------|--------------|---------------|
| Miller           | 9X         | Snyder       | 328-331       |
| Montgomery       | 6X         | Spicer       | 150           |
| Morton           | 367-368    | Stewart      | 39X           |
| Niblet,          | 337-339    | Stierly      | 101-104       |
| Olsen            | 125, 10X   | Stoner       | 221-232       |
| O Penshaw        | 307-312    | Strickhouser | 353-354       |
| Palmer           | 268-271    | Surface      | 154-155       |
| Parks            | 3X, 4X, 5X | Swope        | 369           |
| Parrish          | 176        | Trostle      | 292-294       |
| Pfautz           | 175        | Troy         | 304-306       |
| Poole            | 356-357    | Vandervoort  | 250-251       |
| Powers           | 332        | Wade         | 295-299       |
| Reeves           | 128, 13X   | Wagner       | 247-249       |
| Robertson        | 349-351    | Weixmann     | 131, 18X, 19X |
| Schaefer         | 197-199    | Wheaton      | 156-157       |
| Seaburn          | 165        | Whetzel      | 38X           |
| Shoemaker        | 361-364    | Williams     | 285-286       |
| Sleeman          | 47X        | Wilson       | 233-242       |
| Smith, Eric      | 365-366    | Wise, Kurt   | 318-322       |
| Smith, Katharine | 7X         | Wise, Nolan  | 130           |
| Smith, Lindsay   | 127, 12X   |              |               |
| Smith, Paul      | 43X        |              |               |